



12 Tina Court

London, SW16 2JL

£1,600 PCM

A fantastic two double bedroom purpose-built apartment. The property has a contemporary fitted kitchen and bathroom, natural decoration throughout, and grey wood flooring. The property also benefits from having a communal rear garden. Situated within easy reach of transport and good shopping amenities.

- TWO DOUBLE BEDROOMS
- CONTEMPORARY FITTED KITCHEN
- INTEGRATED KITCHEN APPLIANCES
- STYLISH BATHROOM SUITE
- ALLOCATED PARKING SPACE
- COMMUNAL BIKE STORAGE ON SITE
- CENTRAL HEATING
- COMMUNAL GARDEN
- 14 MINUTES WALK TO WEST NORWOOD STATION
- (WALKING TIMES ESTIMATED BY GOOGLE MAPS)

Viewing

Please contact our Galloways West Norwood Office on 020 8766 6111 if you wish to arrange a viewing appointment for this property or require further information



Floor Plan

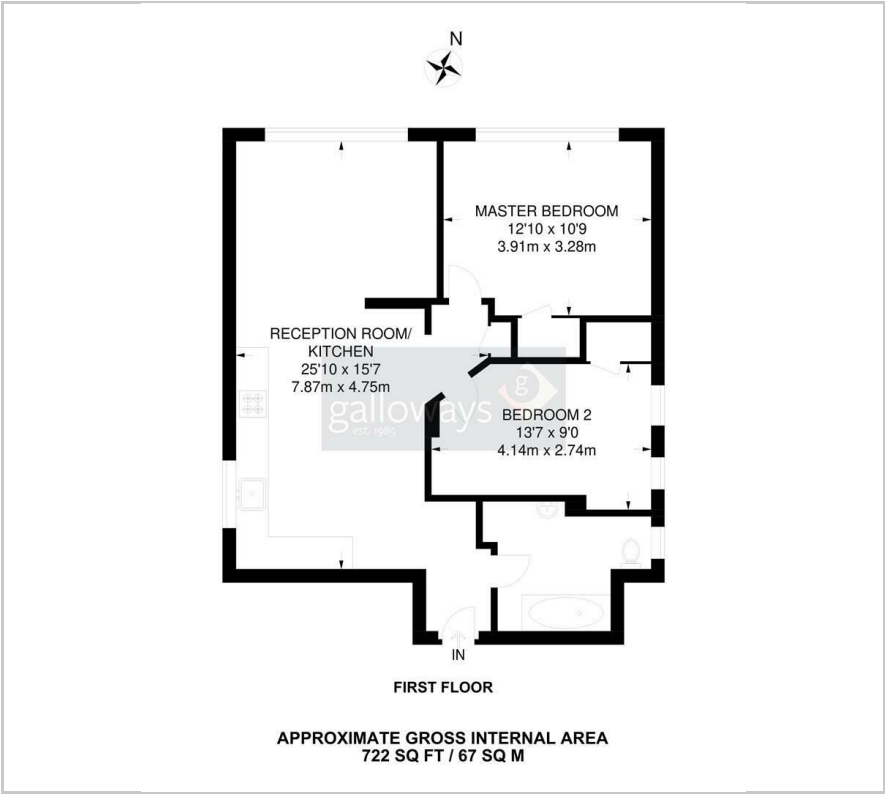

Area Map



Energy Efficiency Graph

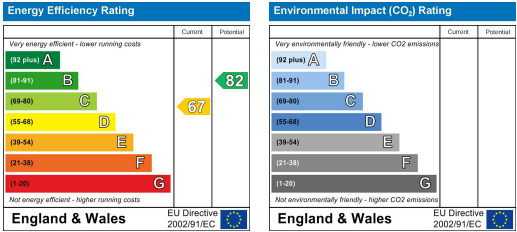

These particulars, whilst believed to be accurate are set out as a general outline only for guidance and do not constitute any part of an offer or contract. Intending purchasers should not rely on them as statements of representation of fact, but must satisfy themselves by inspection or otherwise as to their accuracy. No person in this firms employment has the authority to make or give any representation or warranty in respect of the property.